

COLOR: _____

COLOR TO BE SELECTED FROM ONE OF C/S
60 STANDARD COLORS

INSERT COLOR: _____

PLEASE CHOOSE INSERT COLOR
BLACK - GREEN - PEARL - BRASS - CHROME

TOTAL L/F
REQ'D

END
CAPS

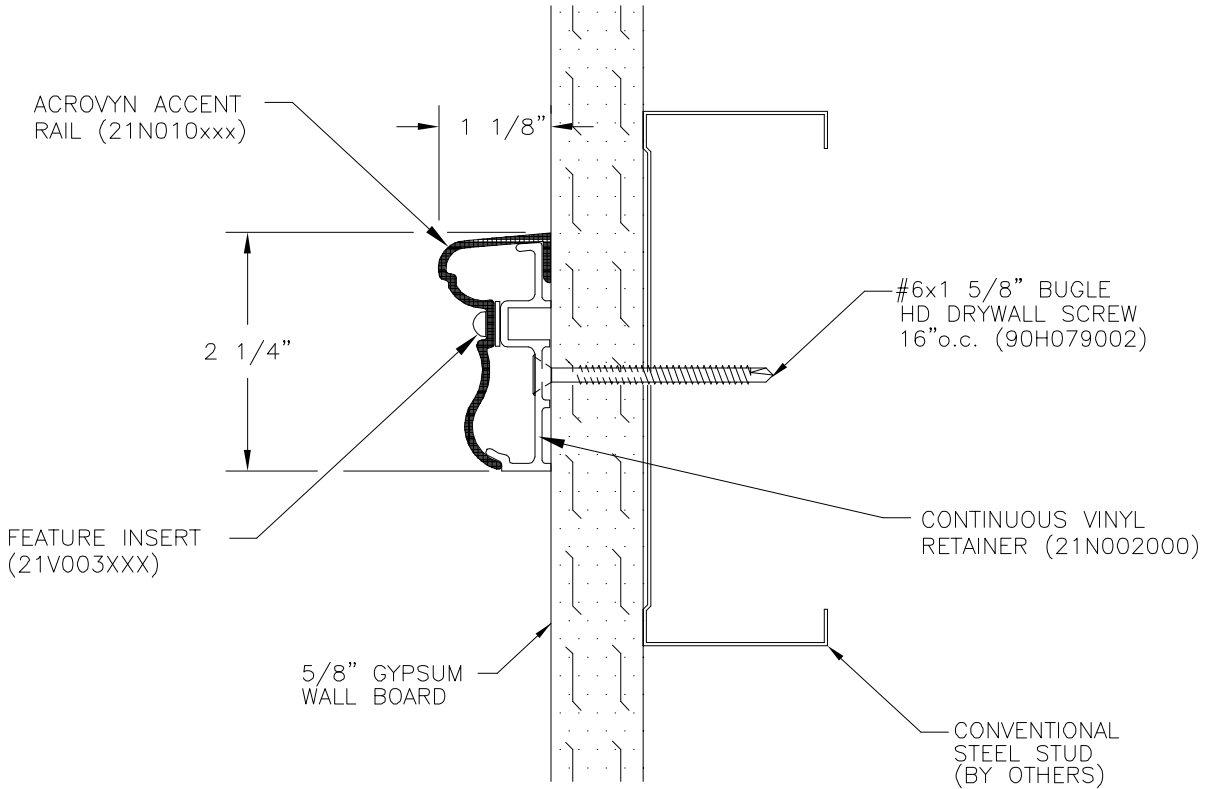

FR-260C

WALL CONDITION	SPECIFIED FASTENER	DRILL DIAMETERS		C/S PART NUMBER
		WALL	RETAINER	
STEEL STUD/GYPSUM WALL	#6 x 1-5/8" BUGLE HD. S.M.S.	N/A	7/64"	90H079002
CONCRETE/CONC. BLOCK	AF-6 ALLIGATOR ANCHOR #10 X 1-1/2" PHILLIPS PAN HD. SMS	1/4"	9/32"	90H039004 90H189002
WOOD STUD/GYPSUM WALL	#6 x 1-5/8" BUGLE HD. S.M.S.	N/A	7/64"	90H079002

C/S GROUP

MUNCY, PA 17756
VISTA, CA 92083
MISSISSAUGA, ONTARIO, CANADA

PROJECT:

REV. :

LOCATION:

F&F:

CUSTOMER:

SHEET OF

AGENT:

JOB NO.

DWG. BY:

DATE:

Section 10260

Suggested Specifications

Part 1 - General

1.01 Summary

- A.** This section includes the following types of wall protection systems:
 - 1.** Accent Rails
- B.** Related Sections: The following sections contain requirements related to this section:
 - 1.** Handrails, Bumper Guards, Crash Rails, Corner Guards; refer to section 10260 “Wall and Corner Guards”
 - 2.** Blocking in walls for fasteners; refer to section 09250 “Gypsum Board Systems”
 - 3.** Wall Covering, Wall Panels, Door Protection; refer to section 09720 “Wall Coverings”

1.02 References

- A.** National codes (IBC, UBC, SBCCI, BOCA and Life Safety)
- B.** American Society for Testing and Materials (ASTM)
- C.** Underwriters Laboratories (UL)

1.03 Submittals

- A.** General: Submit the following in accordance with conditions of contract and Division 1 specification section 01300.
- B.** Product data and detailed specifications for each system component and installation accessory required, including installation methods for each type of substrate.
- C.** Shop drawings showing locations, extent and installation details of accent rails. Show methods of attachment to adjoining construction.
- D.** Samples for verification purposes: Submit the following samples, as proposed for this work, for verification of color, texture, pattern and end cap attachment and alignment.
 - 1.** 12" (304.8mm) long sample of each model specified including end cap and mounting hardware.
- E.** Product test reports from a qualified independent testing laboratory showing compliance of each component with requirements indicated.
- F.** Maintenance data for wall protection system components for inclusion in the operating and maintenance manuals specified in Division 1.

1.04 Quality Assurance

- A.** Installer qualifications: Engage an installer who has no less than 3 years experience in installation of systems similar in complexity to those required for this project.
- B.** Manufacturer’s qualifications: Not less than 5 years experience in the production of specified products and a record of successful in-service performance.
- C.** Code compliance: Assemblies should conform to all applicable codes including IBC, UBC, SBCCI, BOCA and Life Safety.
- D.** Fire performance characteristics: Provide wall protection system components with UL label indicating that they are identical to those tested in accordance with ASTM-E84-01 (CAN/ULC-S102.2) for Class 1 characteristics listed below:
 - 1.** Flame spread: 25 or less

2. Smoke developed: 450 or less

International Fire Ratings Include:

UK: BS476-part 7, Class 1.

France: MI. Spain: MI.

Germany: DIN4102, BI Classification.

Italy: Class 1.

- E. Impact Strength: Provide assembled wall protection units that have been tested in accordance with the applicable provisions of ASTM F476-76.
- F. Chemical and stain resistance: Provide wall protection system components with chemical and stain resistance in accordance with ASTM D-1308.
- G. Color match: Provide wall protection components that are color matched in accordance with the following:
 1. Delta E difference of no greater than 1.5 using the Hunter (Lab) Scale.
(Specifier note: Construction Specialties' colors are matched under cool white fluorescent lighting and computer controlled within manufacturing tolerances. Color may vary if alternate lighting sources are present).
- H. Single source responsibility: Provide all components of the wall protection system manufactured by the same company to ensure compatibility of color, texture and physical properties.

1.05 Delivery, Storage, and Handling

- A. Deliver materials to the project site in unopened original factory packaging clearly labeled to show manufacturer.
- B. Store materials in original, undamaged packaging in a cool, dry place out of direct sunlight and exposure to the elements. A minimum room temperature of 40°F (4°C) and a maximum of 100°F (38°C) should be maintained.
- C. Material must be stored flat.

1.06 Project Conditions

- A. Materials must be acclimated in an environment of 65° - 75°F (18° - 24°C) for at least 24 hours prior to beginning the installation.
- B. Installation areas must be enclosed and weatherproofed before installation commences.

Part 2 - Products

2.01 Manufacturers

- A. Construction Specialties, Inc., Muncy, Pa., Mississauga, Ontario.

2.02 Materials

- A. Vinyl/Acrylic: Extruded material should be high impact Acrovyn with shadow grain texture, .078" (1.98mm) thickness. Chemical and stain resistance should be per ASTM D-1308 standards as established by the manufacturer. Colors to be indicated in the finish schedule from one of manufacturer's standard color range.
- B. Re grind Retainer: Recycled vinyl acrylic compound.
- C. Fasteners: All fasteners to be non-corrosive and compatible with retainers. All necessary fasteners to be supplied by the manufacturer.

2.03 Accent Rails

- A. Vinyl/Acrylic accent rail to be Acrovyn by Construction Specialties: Vinyl acrylic cover shall be securely snapped in place over the continuous regrind retainer. End caps shall be mechanically fastened with concealed fasteners. Color matched end caps and corners to be removable for ease of replacement. Attachment hardware shall be appropriate for wall conditions.
 - 1. Model FR-260C 2 1/4" h (57 mm) traditional colonial style accent rail with (5) vinyl insert options. Select cover from one of (60) Acrovyn solid colors.

2.04 Fabrication

- A. General: Fabricate wall protection systems to comply with requirements indicated for design, dimensions, detail, finish and member sizes.

Part 3 - Execution

3.01 Examination

- A. Verification of conditions: Examine areas and conditions under which work is to be performed and identify conditions detrimental to proper or timely completion.
 - 1. Do not proceed until unsatisfactory conditions have been corrected.

3.02 Preparation

- A. Surface preparation: Prior to installation, clean substrate to remove dirt, debris and loose particles. Perform additional preparation procedures as required by manufacturer's instructions.
- B. Protection: Take all necessary steps to prevent damage to material during installation as required in manufacturer's installation instructions.

3.03 Installation

- A. Install the work of this section in strict accordance with the manufacturer's recommendations, using only approved mounting hardware, and locating all components firmly into position, level and plumb.
- B. Temperature at the time of installation must be between 65° - 75°F (18° - 24°C) and be maintained for at least 48 hours after the installation.
- C. Where splices occur in horizontal runs, splice retainer and vinyl cover at different locations along the run.

3.04 Cleaning

- A. General: Immediately upon completion of installation, clean vinyl covers, and accessories in accordance with manufacturer's recommended cleaning method.
- B. Remove surplus materials, rubbish and debris resulting from installation as work progresses and upon completion of work.

3.05 Protection

- A. Protect installed materials to prevent damage by other trades. Use materials that may be easily removed without leaving residue or permanent stains.